

A:Location planning of anchor-plate2:1

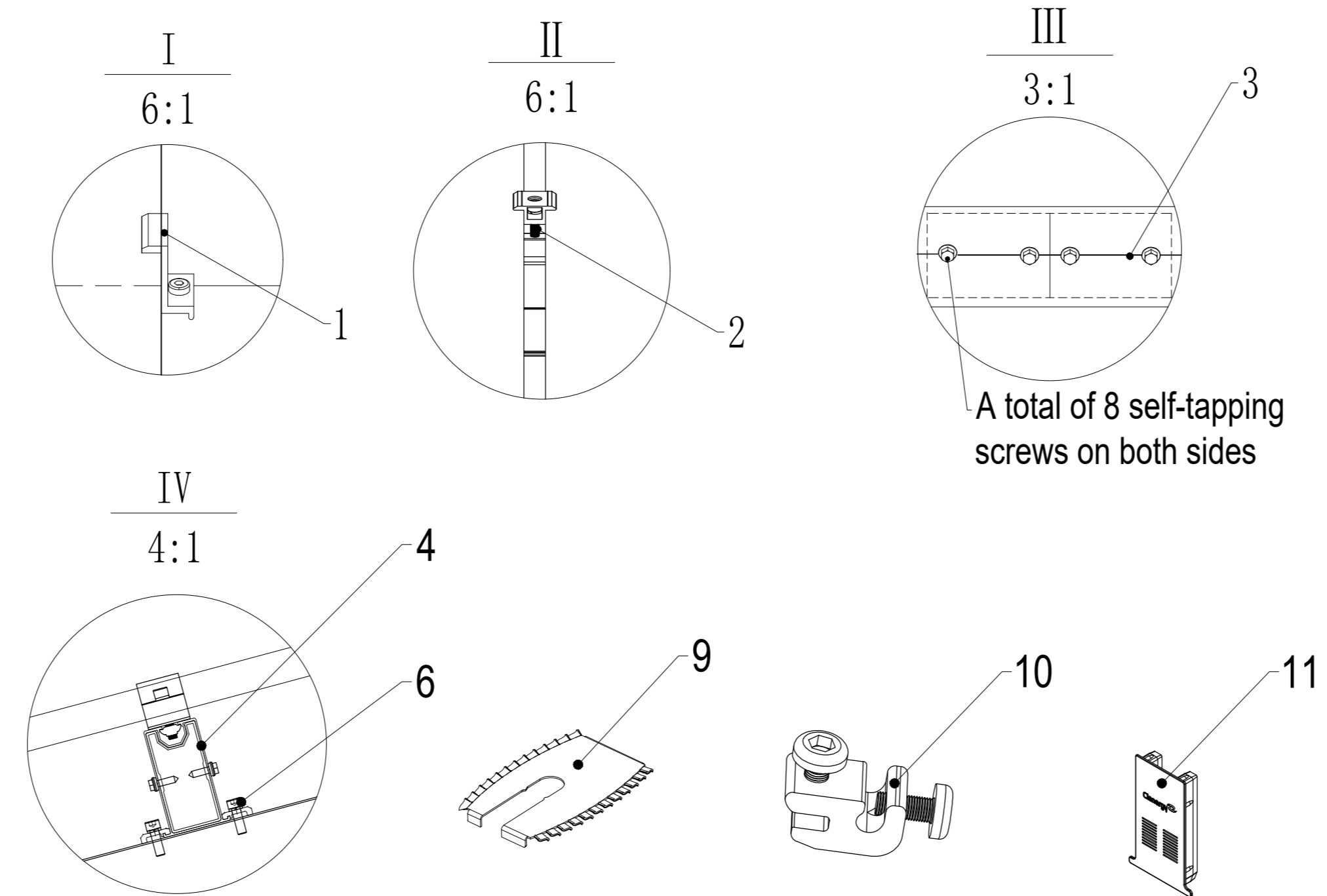
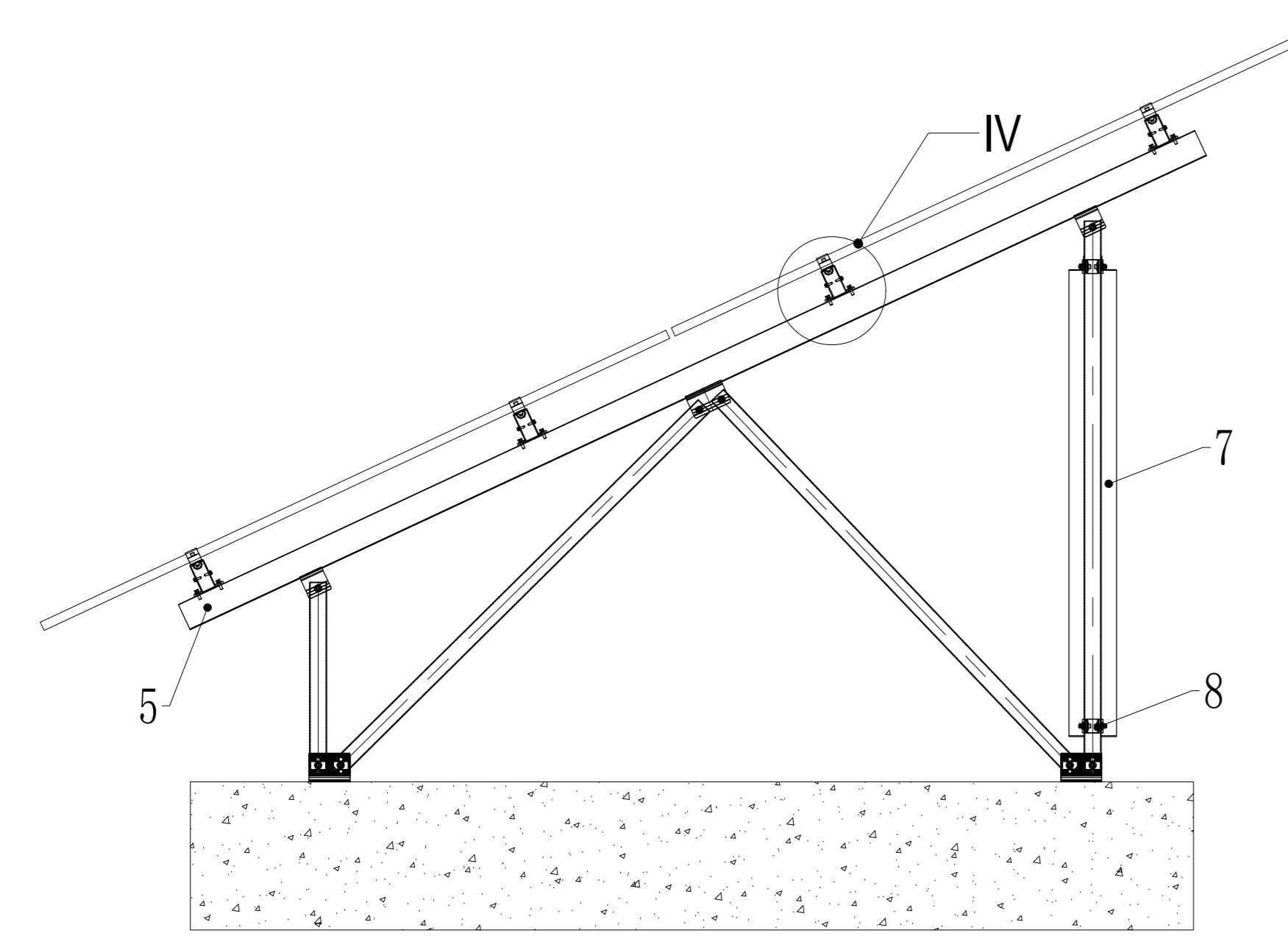

- NOTES:**
- 1.Install angle:25°
 2. Snow load: 0.7KN/m²
 3. Wind load: 34m/s
 4. Panel Type:2278x1134x35
 5. Module per unit:2x7=14
 6. Qty of units:100
 7. Span:2600mm
 - 8.misplacement deviation: ±16mm
 - 9.This design does not contain embedded fasteners

Item	BarCode/Part No.	Drawing NO.	Part Name	Spec.	Material	Qty	Weight:kg	Remark
11	CAP-TW100		Cap for TW Rail 100			8		
10	EZ-GL-U		PV-ezRack Universal Grounding Lug			4		
9	EZ-GCII-ST		ez PV-Grounding Clip II			16		
8	CO-RT-55/50		PV-ezRack Connector for Rectangular Tube 55*50			8		
7	ER-AA-50/2980/8		Angle AL-50.8*50.8*2980with bolt hole Ø8.5			4		
6	ER-RCII/W		PV-ezRack Rail Clamp II with W module			32		
5	S-Eco/W/25/92/3		PV-ezRack SolarTerrace Eco,Support(Pre-assembled,W shape) 25 degree, with 92*3700mm Girder			4		
4-1	R-TW100/4200		PV-ezRack TW Rail 100*4200			8		
3	SP-TW100		PV-ezRack Splice for TW Rail 100			4		
2-1	ER-ICII-W35/38/L50		PV-ezRack Module Inter Clamp II, for Frame Height 35-38mm with W module, Length 50mm			24		
1-1	ER-EC-W35/L50		PV-ezRack End Clamp, Standard 35mm with W module, Length 50mm			8		

				Do Not Scale Drawings, Use Figured Dimensions Only		Version	V 1.0	A3
						清源科技股份有限公司 Cleenergy technology co., Ltd.		
Item	Mark	Design Change No.	Design Change Contents		Sign	Date		
		Appv'D	Chk'D	STD	Proofread	Design		
Sign						Title	STECO 16 panels kit	
Date						Material	Weight	Dwg No. DFG23EU51339-02DW01
						Scale	Qty	Total pages: P View